

PIED-À-TERRE

RESIDENCE 16
FLOORS 15-16

STUDIO | 1 BATH
463 SF

FEATURES

*RAFFLES BOSTON'S RESPITE FOR
URBAN ADVENTURERS*

EXPANSIVE FLOOR-TO-CEILING GLASS
WINDOWS WITH CHARLES RIVER VIEWS

CUSTOM INTEGRATED KITCHENETTE
WITH BUILT-IN APPLIANCES

DUAL CLOSETS

NOTES: _____



PLANS, DIMENSIONS AND FEATURES SHOWN ARE APPROXIMATE AND ARE SUBJECT TO CHANGE WITHOUT NOTICE OR OBLIGATION. VARIATIONS MAY OCCUR DEPENDING, FOR EXAMPLE, ON CONSTRUCTION VARIANCES, LOCATION OF UNIT AND/OR MECHANICAL OR STRUCTURAL REQUIREMENTS.

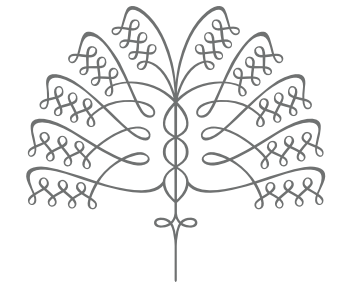
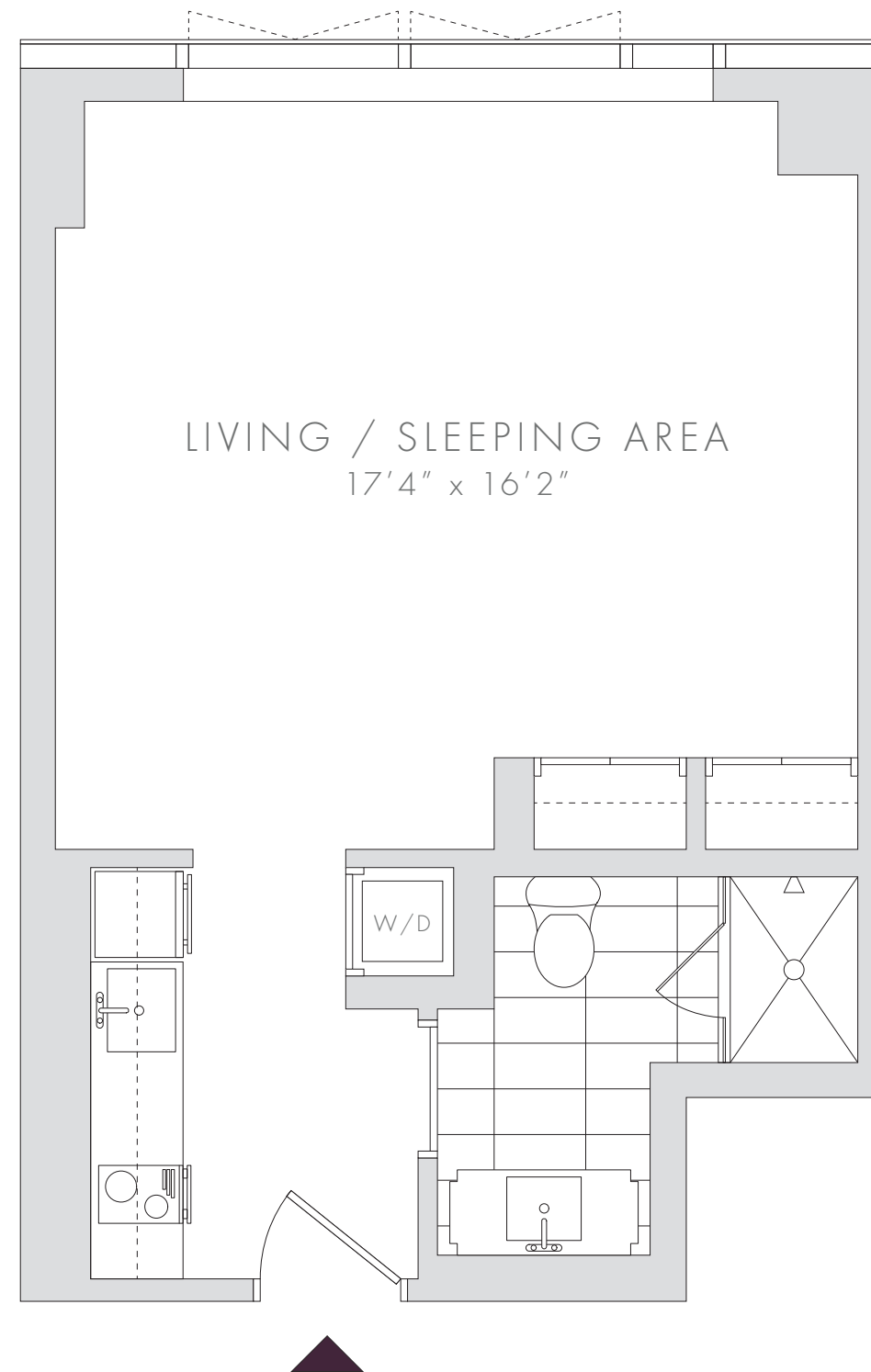

RAFFLES
BOSTON BACK BAY
HOTEL & RESIDENCES

