

## BUILDING FEATURES

THE FIRST RAFFLES HOTEL AND RESIDENCES  
IN NORTH AMERICA

RAFFLES PATISSERIE

SIGNATURE RESTAURANT

SKY LOBBY FINE DINING RESTAURANT

LONG BAR

SKY TERRACE LOUNGE

SPEAKEASY

RAFFLES SIGNATURE WRITERS LOUNGE

RESIDENTS AND GUESTS ONLY RAFFLES SPA

HIS AND HER SAUNA, STEAM AND  
"RAINMOON" SHOWER

PRIVATE TREATMENT ROOMS WITH HYDROTHERAPY AND  
AROMATHERAPY BATHS

COUPLES TREATMENT ROOM WITH HIS AND HER  
HYDROTHERAPY BATHS

20-METER LAP POOL WITH LOUNGE AND  
RELAXATION AREAS

OVERSIZED HOT TUB WITH TROPICAL RAIN SHOWERS

PRIVATE RELAXATION PODS

FITNESS CENTER FEATURING TECHNOGYM EQUIPMENT

RESIDENTS' LIBRARY WITH OUTDOOR TERRACE\*

SECRET GARDEN TEA ROOM\*

NANTUCKET COTTAGE TASTING KITCHEN  
AND WINE LOUNGE\*

SPORTS LOUNGE\*

GOLF SIMULATOR ROOM\*

INDOOR DOG RUN AND PET SPA\*

PRIVATE RESIDENT STORAGE SPACES\*

INDOOR BIKE STORAGE\*

AVAILABLE POWERED COLD OR  
PRIVATE WINE STORAGE\*

*\*Private Residential Amenities*

## RESIDENCE FEATURES

### GENERAL

NINETEEN UNIQUE FLOORPLANS

INTERIORS BY ROCKWELL GROUP WITH AVAILABLE  
ROCKWELL DESIGNED FURNITURE PACKAGE

WIDE-PLANK CUSTOM-STAINED ¾" SOLID CORE  
ENGINEERED OAK FLOOR

ASKO WASHER/DRYER

9'0" HIGH CEILINGS IN LIVING AREAS

SOLID INTERIOR DOORS WITH YALE HARDWARE

ENERGY EFFICIENT FLOOR-TO-CEILING WINDOWS

### KITCHEN

SUPER WHITE MARBLE COUNTERTOP AND BACKSPLASH

STEVALI CUSTOM ITALIAN CABINETRY

CEA DESIGN STUDIO POLISHED CHROME FIXTURES

FRANKE STAINLESS STEEL SINK

HIGHEST QUALITY APPLIANCES:

*WOLF SPEED OVEN*

*WOLF INDUCTION COOKTOP*

*SUB-ZERO INTEGRATED REFRIGERATOR*

*FISHER & PAYKEL INTEGRATED DISHWASHER DRAWER*

### BATHROOM

ELEGANT FOUR-PIECE BATHROOM WITH  
SEPARATE TUB AND SHOWER IN MOST PLANS

STEVALI CUSTOM ITALIAN VANITY WITH DAPHNE  
WHITE MARBLE COUNTERTOP AND KOHLER SINK

ARTICULO PORCELAIN FLOOR AND WALL TILES

APPOINTED WITH JACLO POLISHED  
CHROME FIXTURES

KOHLER DECK-MOUNTED TUB IN MOST PLANS

TOTO TOILET



**RAFFLES**  
BOSTON BACK BAY  
HOTEL & RESIDENCES

*floorplan*  
**PIED-À-TERRE**

**FLOORS 15-16**  
*Residence 14*



**RAFFLES**  
BOSTON BACK BAY  
HOTEL & RESIDENCES

[rafflesboston.com](http://rafflesboston.com)

617 - 882 - 7100

The amenities and project description (including, but not limited to, construction, standard item and buildout descriptions) listed herein and in any other descriptive material are, at the current time, expected to be provided in the Condominium; however, the actual features and amenities may be excluded or modified, including changes, adjustments and substitutions of any materials, appliances, components, labor or other items. All such improvements are subject to the receipt of all applicable governmental permits and approvals. Seller makes no representation or warranty regarding amenities and features at the Condominium. Seller expressly reserves the right to change or deviate from the amenities listed herein.

# PIED-À-TERRE

RESIDENCE 14  
FLOORS 15-16

STUDIO | 1 BATH  
629 SF

## FEATURES

*RAFFLES BOSTON'S RESPITE FOR  
URBAN ADVENTURERS*

SEPARATE LIVING AND SLEEPING AREAS

CORNER HOME WITH NORTHERN AND WESTERN  
EXPOSURES AND CHARLES RIVER VIEWS

EXPANSIVE FLOOR-TO-CEILING  
TRIPLE BAY GLASS WINDOWS

CUSTOM INTEGRATED KITCHENETTE  
WITH BUILT-IN APPLIANCES

SPACIOUS BATHROOM WITH SOAKING  
TUB AND GLASS-ENCLOSED SHOWER

DUAL CLOSETS

NOTES: \_\_\_\_\_  
\_\_\_\_\_  
\_\_\_\_\_  
\_\_\_\_\_

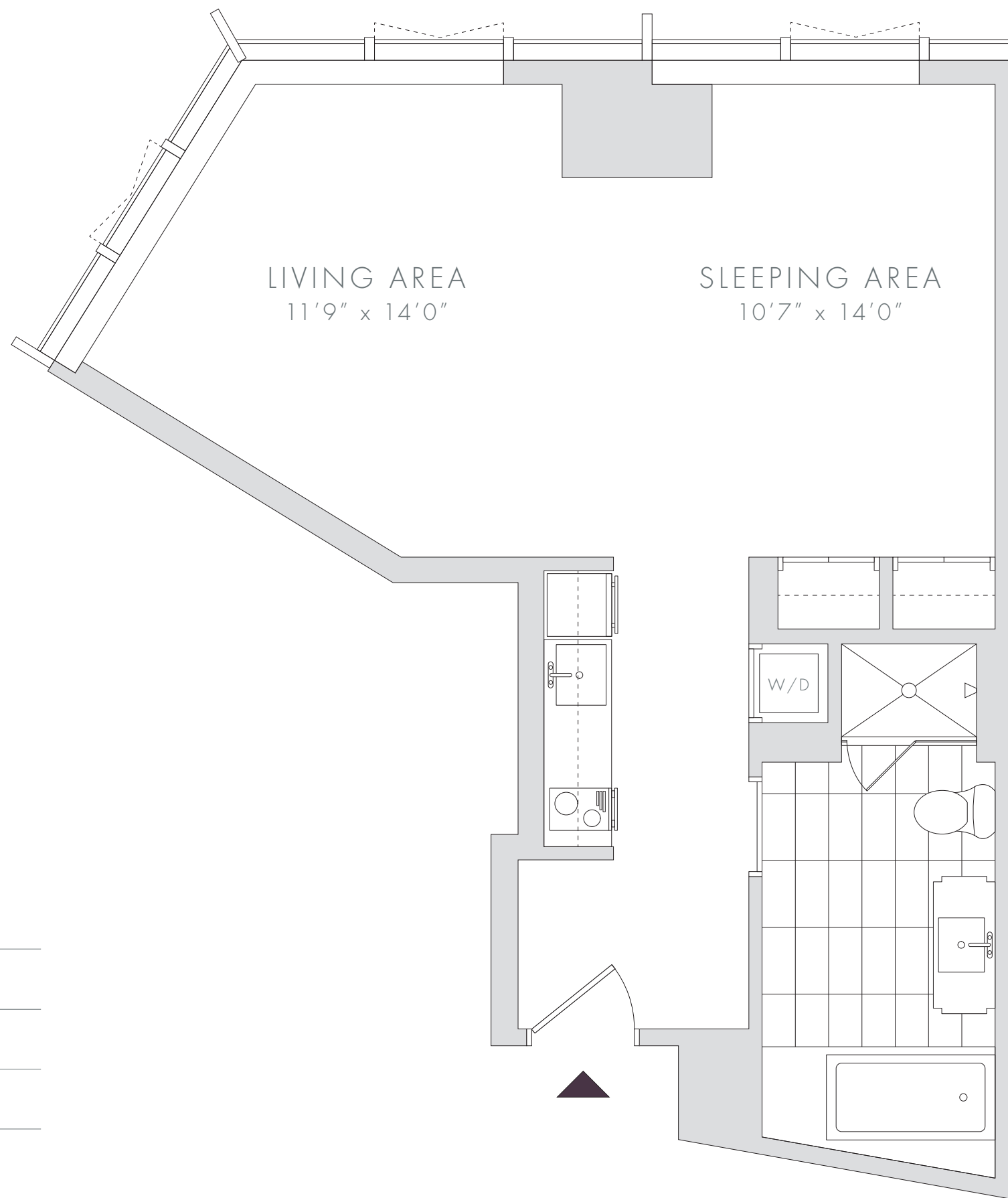

**RAFFLES**  
BOSTON BACK BAY  
HOTEL & RESIDENCES

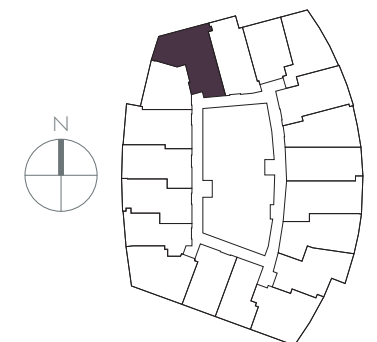

PLANS, DIMENSIONS AND FEATURES SHOWN ARE APPROXIMATE AND ARE SUBJECT TO CHANGE WITHOUT NOTICE OR OBLIGATION. VARIATIONS MAY OCCUR DEPENDING, FOR EXAMPLE, ON CONSTRUCTION VARIANCES, LOCATION OF UNIT AND/OR MECHANICAL OR STRUCTURAL REQUIREMENTS.